

**THOMPSON'S  
THIN  
BRICK**



*The* **ALL NATURAL  
CLEAR CUT DECISION**



# CONTENTS



<b>PARTNERS THROUGH THICK AND THIN</b>	<b>1</b>
<b>THE REAL DIRT ON THIN BRICK</b>	<b>2</b>
<b>THE BORAL COLLECTION</b>	<b>3</b>
<b>THE MCNEAR COLLECTION</b>	<b>9</b>
<b>THE BELDEN COLLECTION</b>	<b>13</b>
<b>THE SUMMIT COLLECTION</b>	<b>17</b>
<b>SPEAKING A NEW LANGUAGE</b>	<b>20</b>
<b>IT'S ALL ABOUT GROUT</b>	<b>22</b>
<b>INSTALLATION INSTRUCTIONS</b>	<b>23</b>
<b>THIN BRICK: MADE TO ORDER</b>	<b>23</b>
<b>INTRODUCING A NEW FORM OF BRICK</b>	<b>24</b>

# Partners Through **THICK & THIN**



Since founding Thompson Building Materials in Tustin, California in 1962, Ken Thompson has developed his once small business into one of the largest building materials distributors on the West Coast. Ken has accomplished this by providing the highest quality customer service, coupled with a genuine respect for each individual.

This honest way of working is how Thompson maintains strong business relationships. For our thin brick line, Thompson represents only the highest quality clay product manufacturers. The company hand picks brick manufacturers from all over the country and overseas, making sure that the products distributed are products Thompson can truly endorse.

And the long-standing relationships with brands such as Boral, Belden, Summit, McNear and our international products are testament to this endorsement. In addition, representatives at Thompson work hard to showcase the integrity of each product, personally delivering samples and providing integral information to all customers.

# *The Real Dirt* **ON THIN BRICK**

Even though it's not always thought of as "green," thin brick is an environmentally sustainable product. Brick has a superior life cycle and can be recycled in any number of ways. But what makes brick unique is that it is made up of two of the most abundant materials in nature: clay and shale, which are products of the earth's surface.

The process is simple. Once the clay and shale are mixed together they are cast in the shape of the desired brick form and fired in a kiln. After cooling, the brick is inspected for quality control and arranged for shipment or immediate use. Virtually all of the material that is harvested is used in the manufacturing, leaving almost no extra waste. This waste containment makes the environmental benefits of brick far superior to many other building materials.

After the brick has been produced, Thompson takes each whole brick and begins the process of creating each thin brick. Depending on the desired look, the brick can be kept as a clean cast or tumbled to produce the effect of rough, worn edges. From here, both faces (of the whole brick) are cut length-wise with a circular saw. The middle is recycled, and the result becomes two pieces of our thin brick product.

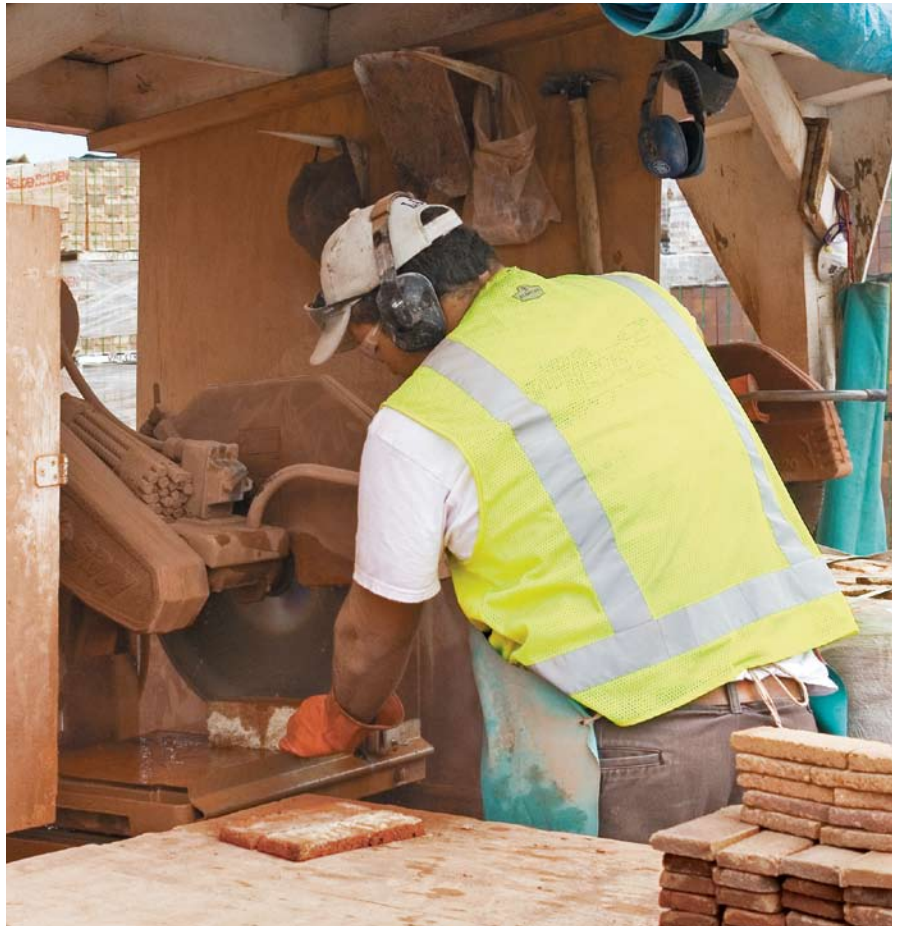

## **THE BENEFITS**

So why thin brick? There are plenty of reasons. The thin brick market in the west has flourished because of a desire for new developments to differentiate themselves and adhere to specific building codes. The product is readily available for homeowners and skilled craftsmen alike, so thin brick veneer can be installed by virtually anyone comfortable with conventional brick installation. Thin brick offers better sound and fire resistance properties than other non-masonry sidings. It is compliant with light-weight cladding laws on buildings and homes, providing more options for urban planning and residential mixes. Thin brick is not only a valuable building material, it is also a safe, economical and environmentally-friendly product.

*The* **BORAL**  
**COLLECTION**



**BORAL  
BUCKSKIN**

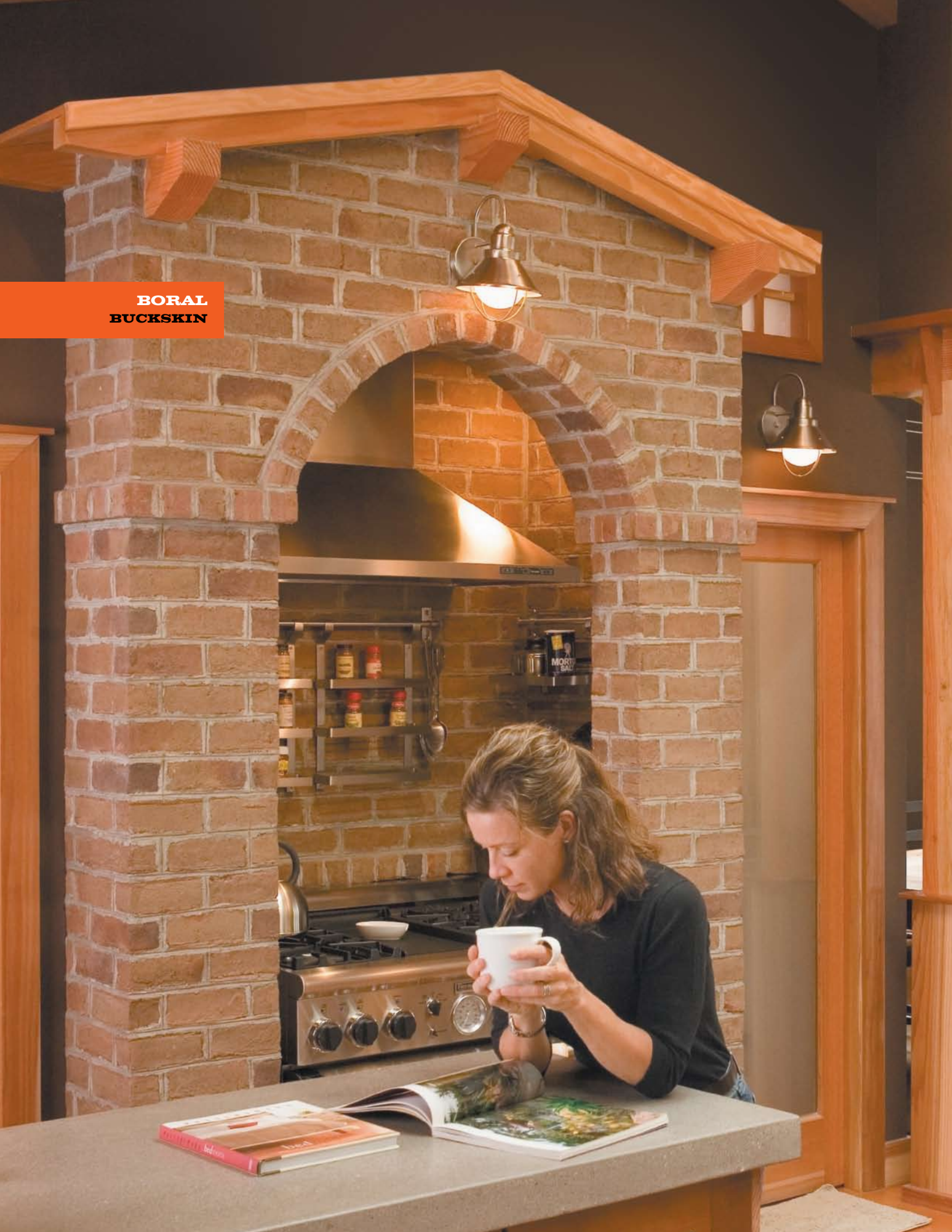

**ALAMO**



**REGENCY**



**BUCKSKIN**



**MISTY BAY**



**MT. RUSHMORE**



**ORLEANS**



**ORTEGA**



**CHATEAU**



**LAREDO**



**SMITHSONIAN**





**TONY ROMA'S**  
FAMOUS FOR RIBS

**BORAL  
SMITHSONIAN**



## CAMBRIDGE



## WERACOBA 2



## MOSSWOOD



## *Boral Thin Brick* MEASUREMENTS

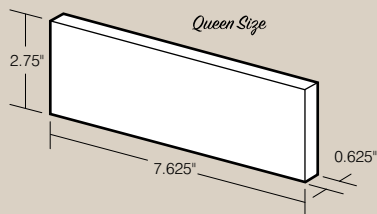

**FLATS**

THICKNESS MAY VARY

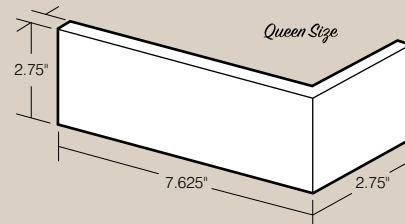

**CORNERS**

THICKNESS MAY VARY

*The* **MCNEAR**  
**COLLECTION**





**MCNEAR**  
**CASCADA TUMBLED**

**SANTIAGO STANDARD**



**SANTIAGO TUMBLED**



**CASCADA STANDARD**



**CASCADA TUMBLED**



**DORADO STANDARD**



**DORADO TUMBLED**



**MCNEAR  
SANTIAGO TUMBLED**



*McNear Thin Brick* **MEASUREMENTS**

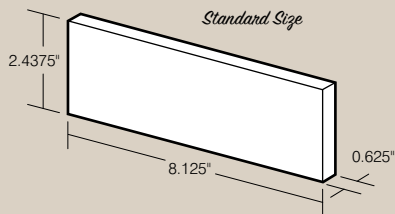

**FLATS**

THICKNESS MAY VARY

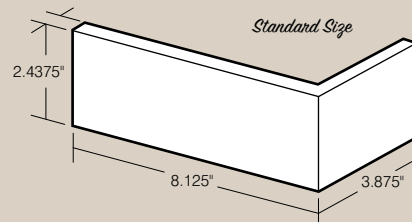

**CORNERS**

THICKNESS MAY VARY

*The* **BELDEN**  
**COLLECTION**



**BELDEN**  
**MOJAVE BLEND**





**BRIDGEPORT BLEND**



**ALAMO**



**MOJAVE BLEND**



**MEADOW BLEND**



**BEECHWOOD**



**PRINCESS BLEND**



**BELCREST 150**



**BELCREST 360**



**BELCREST 530**



**BELCREST 730**



*Belden Thin Brick* **MEASUREMENTS**

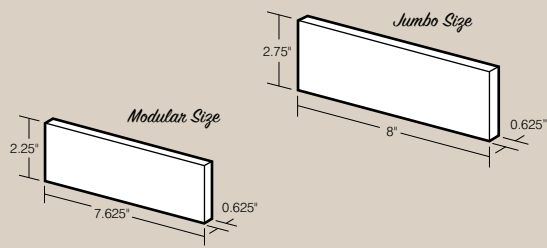

**FLATS**

THICKNESS MAY VARY

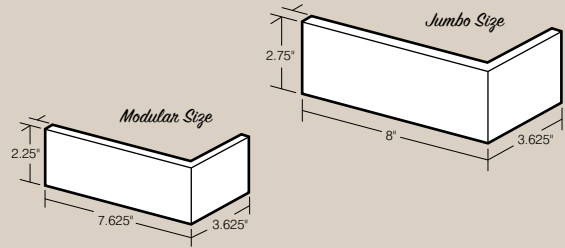

**CORNERS**

THICKNESS MAY VARY

*The* **SUMMIT  
COLLECTION**





**SUMMIT  
MOROCCO**

**EMPIRE GOLD**



**KNOWLWOOD BLEND**



**MOROCCO**



**ANACONDA**



*Summit Thin Brick* **MEASUREMENTS**

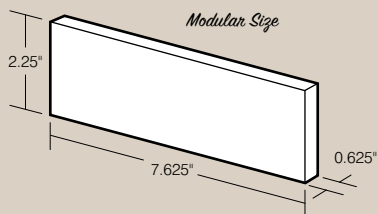

**FLATS**

THICKNESS MAY VARY

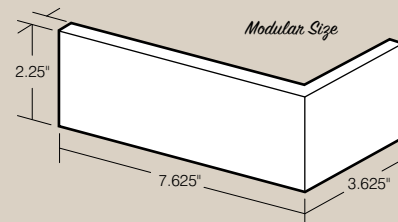

**CORNERS**

THICKNESS MAY VARY

# Speaking **A NEW LANGUAGE**

For nearly a decade, owner Ken Thompson and other Thompson representatives have journeyed to various regions of the world in pursuit of quality building materials. While traveling throughout Italy, the coastal towns of Australia and the Scandinavian communities of Denmark, the Thompson team has discovered building products of great renown. Their most recent trip to Italy included tours of historical landmarks, ancient ruins, monumental architecture and smaller Tuscan neighborhoods to gain a greater understanding of authentic old-world European brick; how it's manufactured, what its distinct characteristics are and how it's installed. Consequently, they discovered manufacturers who still make brick the way it was made decades ago.

The Thompson team met with these manufacturers and witnessed unsurpassed quality and craftsmanship. A mutual relationship was arranged so that the highest quality brick could be imported directly to Thompson's Southern California facility to be transformed into Thompson Thin Brick.

For more information on these international brick products please contact your Thompson Sales Representative.

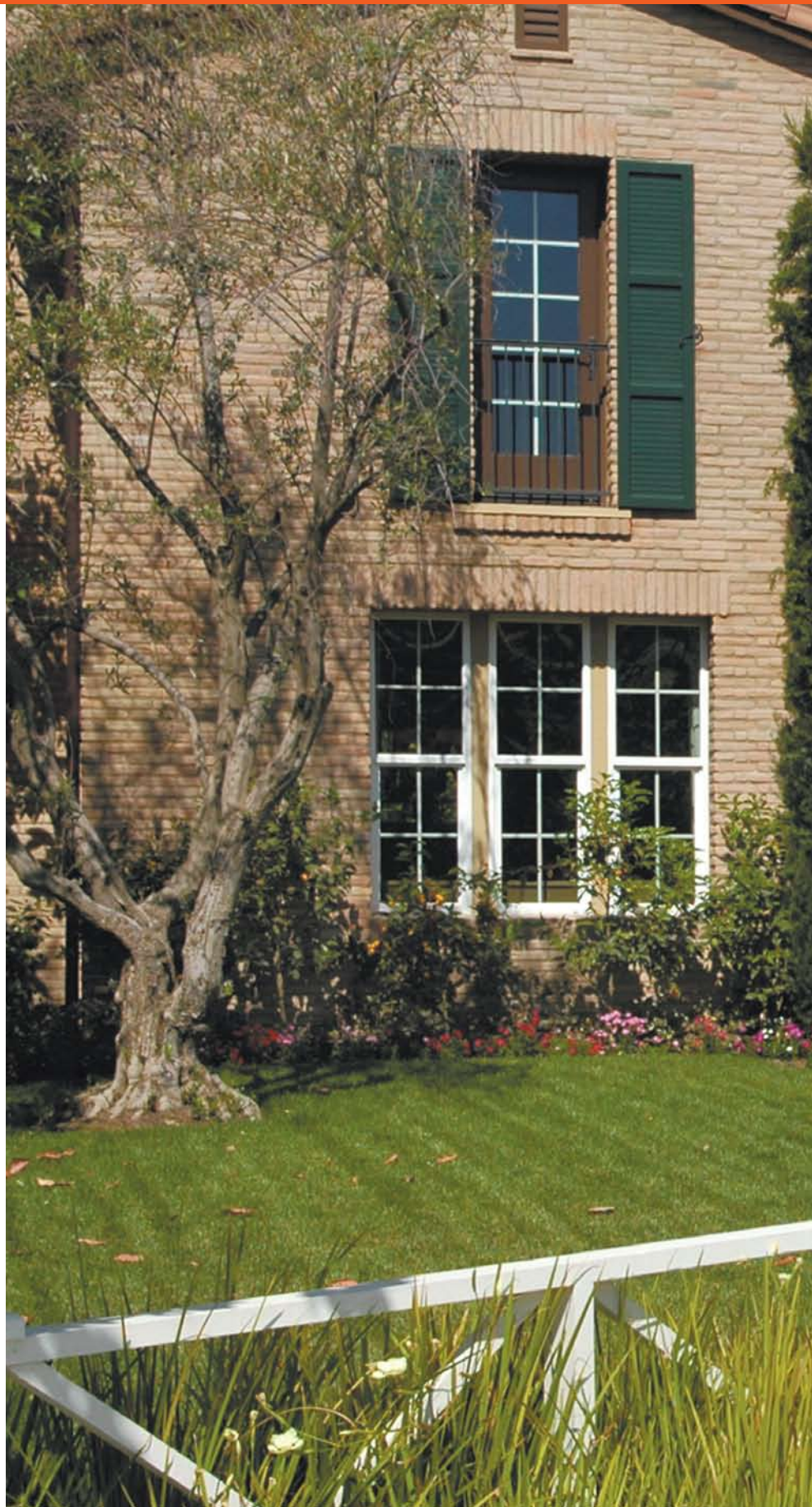

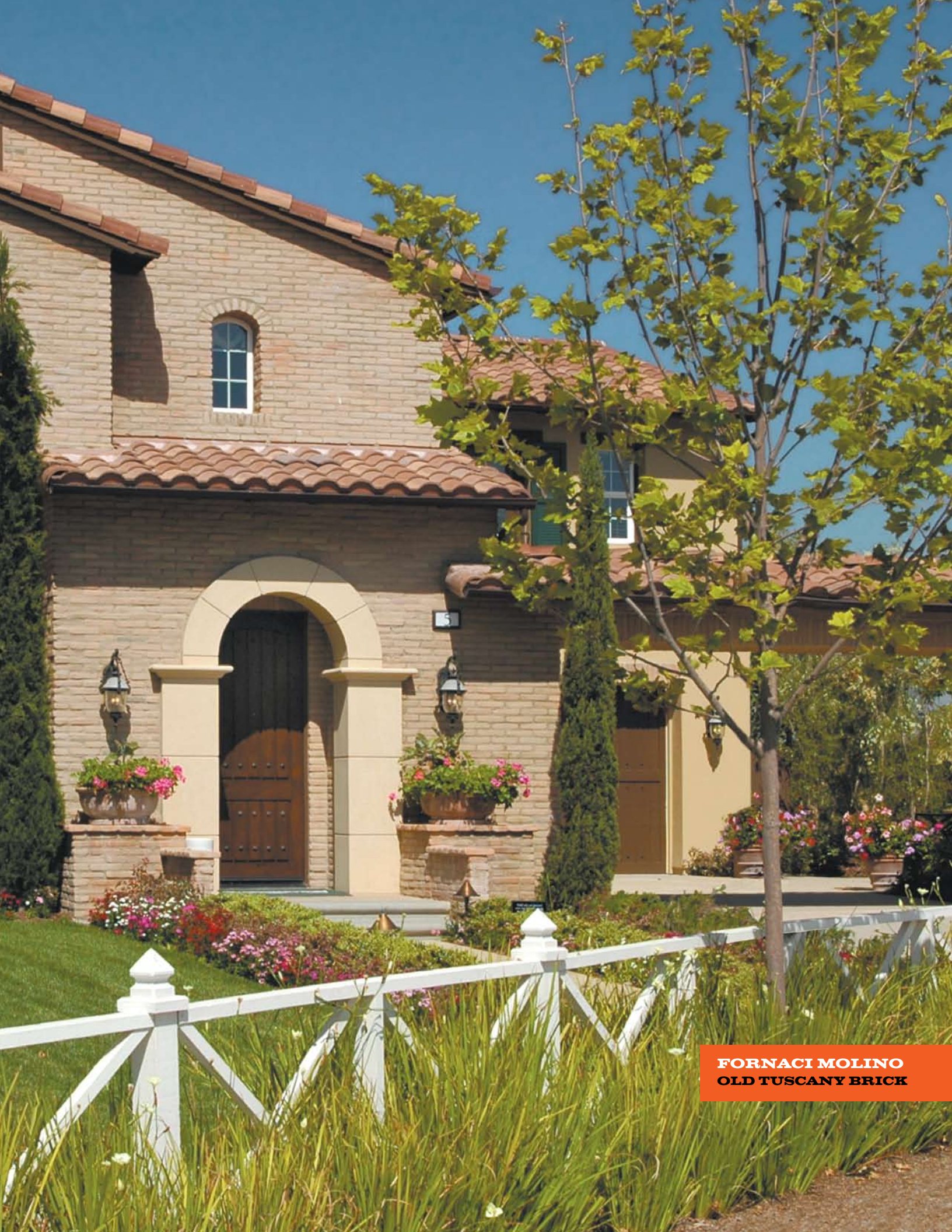

**FORNACI MOLINO**  
**OLD TUSCANY BRICK**

# IT'S ALL ABOUT GROUT

Grout is more than just a mixture of water, cement and sand—it is an essential part of the appearance of brick, and especially thin brick. That means your grout choice needs to be a good complement in color, style and technique to your thin brick selection.

There are many different styles of

grouting that you can choose to change the overall look and feel of your project.

Grouting techniques are often referred to as “finishes” or (more commonly) as “joints,” such as a standard joint, which is a technique that creates a smooth, consistent depth from the face of the brick. Many other joint techniques

—such as full or weep joint—give the installation unique personalities.

Consult with a mason or other reference materials to explore the many finish techniques. In addition to these various grout techniques, the grout color choice will also be important in the overall appearance of your brick installation.



## STANDARD GRAY *Colored Grout*

Standard gray grout color tends to be a cooler mixture. When combined with a warmer brick color subtle values of the brick are exposed as greater contrast is achieved. Matched with a cooler brick color, hues tend to be more subdued which creates a consistent overall value.



## WARM GRAY *Colored Grout*

An alternate gray grout color can look warmer in value. Placing a warm brick color in combination with a warmer gray grout tends to mute both colors creating an overall even value. Alternatively, a cooler brick color will accentuate the cooler values of the brick.



# INSTALLATION INSTRUCTIONS

After the selection of thin brick, grout technique and grout color, careful attention must be paid to the installation. In the illustrations below, three common installation techniques are shown for three different standard substrate surfaces. These illustrations are general so check with local building codes and specific product instructions for critical installation information.

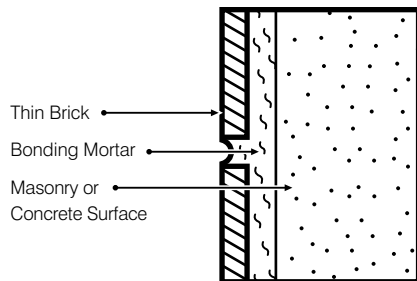

## *Direct Application to Masonry or Concrete Surfaces*

- No surface preparation is necessary
- For added support, use a metal lath and scratch coat
- Newly poured concrete should be examined for form oil or other release agents
- Treated or painted surfaces must first be sandblasted to original surface

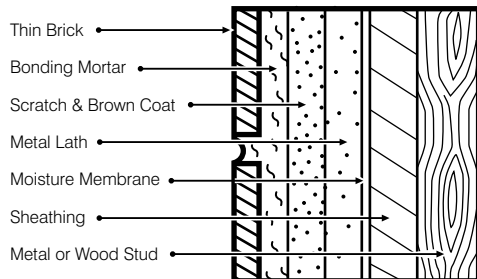

## *Metal or Wood Stud/Sheathing/Metal Lath/Mortar Method*

- Cover wall surface with a weather-resistive barrier
- Install diamond mesh expanded metal lath or woven wire mesh to stud wall
- Attach lath using galvanized nails penetrating studs at least 1"
- Apply 1/2" thick scratch coat of mortar over metal lath and let sit for 48 hours

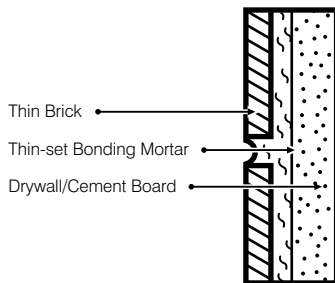

## *Interior Surfaces*

- Treated or painted surfaces must first be sandblasted to original surface
- Apply thin-set mortar or adhesive to Drywall/Cement Board
- Apply grout and thin brick

## THIN BRICK: MADE TO ORDER

With Thompson's large inventory of brick, and brick manufacturers, the thin brick line isn't just limited to what is presented in this brochure. Thompson can custom cut any brick in stock or any brick that the manufacturers produce. Please contact your Thompson Sales Representative for more information.

# Introducing **A NEW FORM OF BRICK**

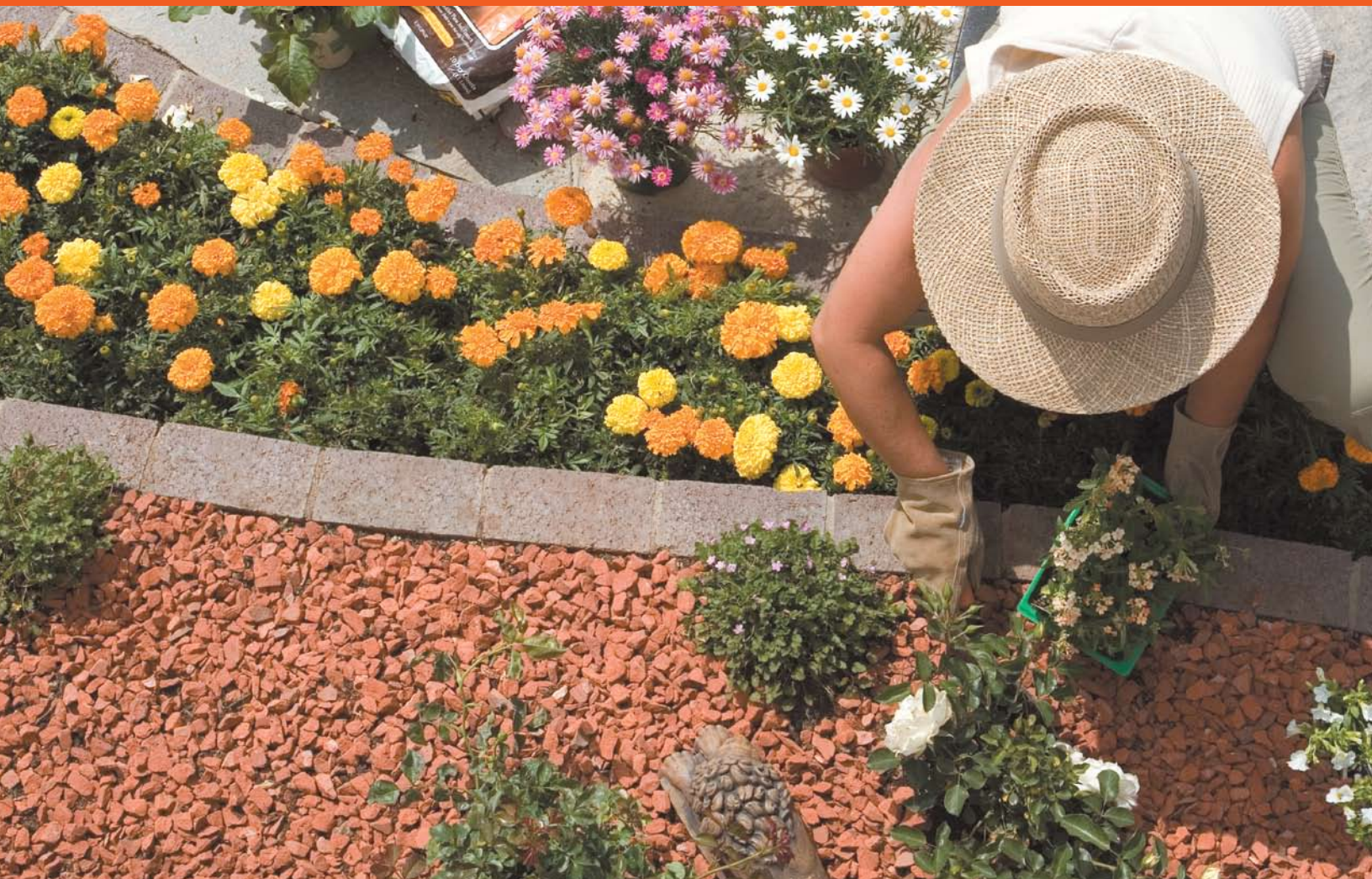

Earlier in this brochure Thompson's process on how thin brick is "thinned" was described. That process leaves excess brick that can be recycled. Since brick is such a versatile material the residual brick can be used in a number of ways.

One way the excess brick is recycled is by utilizing smaller, broken pieces in landscaping. When the leftover brick is ready to be recycled it is often broken

into small pieces. These smaller brick pieces are perfect for gardens and walkways, or around trees and plants. And since the brick is made of clay and shale, its "green" properties make it the perfect complement to any landscape.

Another landscaping option for excess brick is to recycle it into useful ground cover allowing brick particles to mix back into the natural environment. When brick

is crushed small enough it can become a fine granular product and used instead of dirt or other ground cover. The crushed brick particles can be used for parks and trails, even baseball diamonds.

This recycled ground cover and the crushed brick pieces are available at all Thompson's locations. Please contact your Thompson Sales Representative for more information.

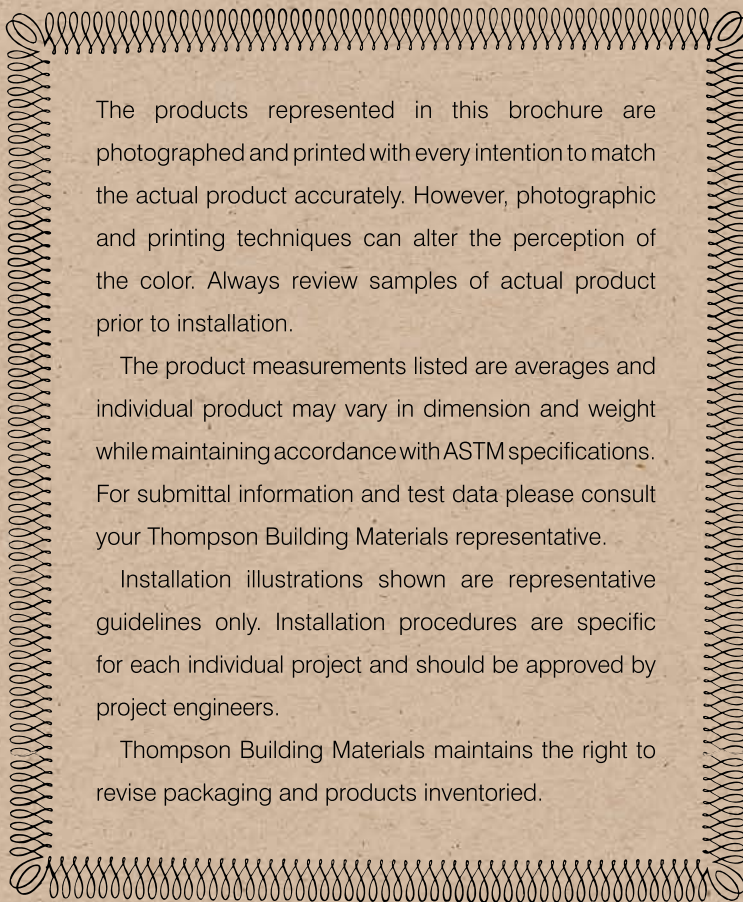

The products represented in this brochure are photographed and printed with every intention to match the actual product accurately. However, photographic and printing techniques can alter the perception of the color. Always review samples of actual product prior to installation.

The product measurements listed are averages and individual product may vary in dimension and weight while maintaining accordance with ASTM specifications. For submittal information and test data please consult your Thompson Building Materials representative.

Installation illustrations shown are representative guidelines only. Installation procedures are specific for each individual project and should be approved by project engineers.

Thompson Building Materials maintains the right to revise packaging and products inventoried.



**THOMPSONBLDG.COM**

*For all of your masonry needs, call us today at one of our many locations!*

ORANGE  
714.935.0900

ORANGE  
714.998.9337

ORANGE  
714.637.7373

FONTANA  
909.350.3000

CAMARILLO  
805.484.4391

WILMINGTON  
310.830.5584

LOMITA  
310.326.5160

LEMON GROVE  
619.287.9410

*Corporate*

*Design Center*