



STONE

your NATURAL choice

Proud producers of OCEAN PEARL NATURAL STONE



NANAIMO . VICTORIA . SURREY . CALGARY . EDMONTON . KELOWNA

www.K2STONE.ca



your NATURAL choice

GREAT CUSTOMER SERVICE IS OUR CORNERSTONE

At K2 Stone, we endeavor to create an environment where positive customer experiences are the norm - not the exception. We are committed to providing elite natural stone products and personalized service to our customers for a price that makes sense. We invite you to discover why architects, developers, builders, stonemasons and homeowners across North America are making K2 their choice for building and landscaping stone.

Sourced from our quarry on the West Coast of Vancouver Island, Ocean Pearl is an all-natural metamorphic slate, unique in the world - New Zealand is the only other place it has been found. We use highly specialized equipment and quality control procedures to ensure that our products exceed expectations, and provide a lasting, cost effective alternative to artificial stone.

From our production facility and show room in Nanaimo to all our show room locations in Victoria, Surrey and Calgary and our dealers in the USA, we make stopping by an easy task. Drop by for a coffee and a tour sometime, and allow us to show how we can help you achieve a beautiful, durable and affordable new look for your home or garden.



your NATURAL choice

WHY CHOOSE NATURAL STONE OVER ARTIFICIAL STONE?

DURABILITY

Natural stone will not fade or wear over time; in fact it looks better with age.

UNIQUENESS

Natural stone has its own unique characteristics; no two pieces are exactly alike because it is not made from a mold.

WORKABILITY

Natural stone can be shaped, trimmed and chiseled to take on any specifications without losing any coloration or effect.

NATURAL COLOUR

The vibrancy and life of natural stone cannot be captured or duplicated by any painted product.

COST EFFECTIVE

At K2 Stone, we list our natural stone profiles at prices that are competitive with artificial stone products - and invite you to compare.

GREEN

Our product and practices are recognized for their environmental stewardship by the Canada Green Building Council and the Built Green Society of Canada.

K2 STONE - DON'T SETTLE FOR IMITATION.



NANAIMO . VICTORIA . SURREY . CALGARY . EDMONTON . KELOWNA

www.K2STONE.ca

NANAIMO . VICTORIA . SURREY . CALGARY . EDMONTON . KELOWNA

www.K2STONE.ca



From the outer crust of the mountain comes our most popular profile - Ocean Pearl Natural Ledgestone. This stone is characterized by its warmth and subtle strength and is preferred by masons for the ease with which it can be shaped. With its naturally weathered texture and earth-tone colour range, Ocean Pearl Natural Ledgestone beautifully accents any application outside or inside your home or office.

Available in both 1-inch Thinstone (with matching corners) and 4-inch Full Bed Ledgestone.





your NATURAL choice

Found in the heart of the mountain, the beauty of K2's Pacific Ashlar begins with its simplicity. This versatile blue-grey stone can reproduce the look, texture and strength of an old style castle stone, or the sleek and contemporary lines found on many of today's modern homes and restaurants. The occasional white quartz striation provides dynamic natural veins, and helps set Pacific Ashlar apart from other dimensional stone profiles.

Pacific Ashlar is available in 1-inch Thinstone, and in 2, 4, 6 and 8-inch cut heights with random lengths. Matching corners are available in 4, 6 and 8-inch cut heights.





your NATURAL choice

K2 Stone's unique fieldstone Arbutus is found deep within the natural fissures of the quarry. Random in shape and rich in colour, Arbutus Fieldstone can be used on its own to create bold and imposing architectural characteristics. You can also combine it with our other ledgerstones to create a warm, comfortable blend of natural elements.

Arbutus Fieldstone Veneer is available in 1-inch Thinstone (with matching corners) and 4-inch Full Bed Stone.





The veins of the mountain produce a striking white quartz line that highlights K2's Black Pearl LedgeStone. The Black Pearl profile effectively blends the popularity of a LedgeStone with the demand for colour consistency. It is rich in texture, yet soft in appearance, which gives pleasing neutrality to any exterior or interior architectural application.

Black Pearl is available in both 1-inch Thinstone (with matching corners) and 4-inch Full Bed LedgeStone.



your NATURAL choice

A huge quarry deposit of rich blue and green tones has led to the development of a new profile - K2's Ocean Mist. Available in LedgeStone, Ocean Mist lends itself to contemporary styles with clearly defined lines and vivid colour.

Ocean Mist LedgeStone is available in both 1-inch Thinstone (with matching corners) and 4-inch Full Bed LedgeStone.





Natural



Ocean Mist



Arbutus



Tofino Sky



Black Pearl



Pacific Ashlar



Carmanah Cobbles



Ashlar Cobbles

TOFINO SKY FIELDSTONE



CARMANAH COBBLE VENEER



Another of K2 Stone's fieldstones is the blue-green Tofino Sky which comes from the same quarry deposits as Ocean Mist. Random shapes and good coloration of K2's Tofino Sky adds character and beauty to your architectural designs.

Tofino Sky is available in 1-inch Thinstone (with matching corners).

Shaped and softened by tumbling; K2's Carmanah Cobble Thinstone is used to recreate a classic look found on thousands of fireplaces, chimneys, and cottages world-wide. Random shapes and uniform colour, this profile provides a simple and subtle feel to any space.

Carmanah Cobble is available in 1-inch Thinstone (with matching corners).





The consistency of both quality and appearance from K2 Stone has led many architects and builders to blend profiles. We would be happy to assist you with samples as you explore the endless possibilities of mixing and matching our different profiles of K2 Stone.





Put the finishing touches on your residential or commercial project with K2's assortment of trim and accent stones. Whether you desire the matching consistency of Ocean Pearl or the effective contrast of our Newcastle Sandstone, we can produce what you need - cobbles, capping, keystones, and more.



We are proud to offer the capability to produce customer-specific stone profiles for some of North America's finest builders and custom home projects. The size of our quarry, our specialized equipment and the quality of our staff allows us to fine tune large orders that our competitors cannot match. Contact K2 Stone to discuss how we may be able to meet the needs of your unique project.





your NATURAL choice

There are limitless possibilities of what you can do with natural stone around your home and garden. Whether you are a landscaper creating a massive park, or a homeowner with dreams of a backyard oasis, the versatility and striking natural beauty of stone will complement your design. From small stones to huge slabs, K2 Stone has you covered: *Flagstone, Wallstone, Gurglers, Benches, Stepping Stones, Cobbles, Saucers, Pond Rocks, Columns, Slabs, Stairs, Geospheres.*



STONE



PRODUCT	DESCRIPTION	PALLET DIMENSION	APPROX. PACKAGE WEIGHT	APPROX. COVERAGE	UNIT
Thinstone Ledgestone Veneer Flats (Natural, Ocean Mist, Black Pearl)	Cut Back • 3/4" - 1 1/4" thick Min 3" x 6" flat edge grain • 10-13lbs/sq ft	4' x 4' x 16"	1200lbs	100 sq ft / pallet	Sq Ft
Thinstone Fieldstone Veneer Flats (Arbutus, Tofino Sky, Carmanah Cobbles)	Cut Back • 3/4 - 1 1/4" thick Min 6" x 6" flat face grain • 10 - 13 lbs/sq ft	4' x 4' x 16"	1200lbs	100 sq ft / pallet	Sq Ft
Thinstone Pacific Ashlar Flats	Cut top and bottom • 3/4" - 1 1/4" thick 2", 4", 6", 8" height • Random lengths	4' x 4' x 16"	1200lbs	100 sq ft / pallet	Sq Ft
Thinstone Veneer Corner	Min 2" height • 4" Outside return Thinstone specs	40" x 4' x 16"	800lbs	50 lineal ft / pallet	Lineal Ft
Full Bed Ledgestone	4" Thick +/- 1/2" • Min 6" length • Min 3" height	4' x 4' x 36"	4000lbs	40-45 sq ft / ton	Ton
Full Bed Ledgestone Cut Corner	Min 2" height • 6" Outside return • Ledgestone specs	4' x 4' x 26"	3200lbs	50 lineal ft / pallet	Lineal Ft
Stand-up (Select) Flagstone 2"	4 sq ft area per piece	4' x 4' x 36"	4000lbs	70 sq ft / ton	Ton
Stand-up (Select) Flagstone 1.5" minus	4 sq ft area per piece	4' x 4' x 36"	4000lbs	100 sq ft / ton	Ton
Lay-down (Patio) Flagstone 2"	1-4 sq ft area per piece	4' x 4' x 36"	4000lbs	70 sq ft / ton	Ton
Lay-down (Patio) Flagstone 1.5" minus	1-4 sq ft area per piece	4' x 4' x 36"	4000lbs	100 sq ft / ton	Ton
Wall Stone	Smallest piece about 3" thick x 10" long Largest piece about 10" thick x 24" long All bed depth will be between 6" - 12" All pieces will be stackable	4' x 4' x 36"	4000lbs	25 sq ft / ton	Ton
Cut Wall Stone	Cut top and bottom to 8" in height 10" - 12" depth • Random lengths	4' x 4' x 36"	4000lbs	12 sq ft / ton	Ton
Stepping Stones	Minimum 10" up to 30" in diameter 2" - 3.5" in thick random shapes • Tumbled	4' x 4' x 36"	4000lbs	100-110 pcs / pallet	Ton
Antiqued Saucers	2" - 3" Thick • 4" - 6" Diameter Random circular shapes • Tumbled	4' x 4' x 36"	4000lbs	400-500 pcs / pallet	Ton
Cobbles	Split to 2 1/2" Thickness 4" x 8", 6" x 8", 8" x 8" • Tumbled	4' x 4' x 26"	4000 lbs	100 sq ft / pallet	Sq Ft

CAPPING STYLE	DESCRIPTION	WIDTHS	LENGTHS	THICKNESS
Premium Capping	Cut top, bottom, back with flamed front	3", 4", 6", 8" standard widths	Random lengths 2 ft and greater	2"
Standard Capping	Natural top and bottom, cut back, cut and flamed front	3", 4", 6", 8" standard widths	Random lengths 2 ft and greater	2"
Newcastle Capping	Cut top, bottom, back, and flamed front	3", 4", 6", 8" standard widths	Random lengths 2 ft and greater	2"

OCEAN PEARL METAMORPHIC SLATE TESTING RESULTS

Density and Absorption, ASTM C 97	0.10%
Compressive Strength, ASTM C 170	124 MPa
Resistance of Rock to Freezing and Thawing (CRD-C-144-92)	0.0168%
Colour range	Browns, oranges, golds, greens, greys and blues

SURFACE PREPARATION FOR INSTALLATION OF NATURAL THINSTONE VENEER

EXTERIOR FRAMED WALLS

Note - Installation applies to both wood and steel stud framed walls. (See Figure #2)

Installation applies both to wood and steel stud framed walls. Material, size and spacing needs to be in compliance to local building codes and/or any manufacturers structural requirements.

An exterior sheathing material is required to provide a base for the application surface. Cover sheathing with weather resistant vapor barrier. Lap vapor barrier at the joints by a minimum of 4 inches. Install 2.5 lb galvanized expanded metal lath with galvanized nails or screws. Fasteners should be installed at a minimum of 6 inches on center vertically and 16 inches horizontally. It is important to note that in a corner application, the expanded metal lath needs to wrap the corner completely and overlap the expanded metal lath to a minimum of 4 inches. Apply 1/2 inch thick scratch coat, allow 24 hours to dry, and your Natural Thinstone Veneer can now be applied.

INTERIOR FRAMED WALLS

Note - A wall board is required to provide a base for the application surface. (See Figure #2)

Install a vapor barrier and 2.5lb galvanized expanded metal lath over wall board with recommended galvanized nails or screws. Expanded metal lath over concrete board is not necessary unless local building codes require it. Concrete board that is properly installed can have Natural Thinstone Veneer applied right to it. Fasteners should be installed at a minimum of 6 inches on center vertically and 16 inches on center horizontally. It is important to note that in a corner application, the expanded metal lath needs to lap over the expanded metal lath that is applied to each adjacent wall surface by a minimum of 4 inches. Apply 1/2 inch thick scratch coat, allow 24 hours to dry, and apply the Natural Thinstone Veneer.

EXISTING CONCRETE MASONRY WALL

Note - Including sealed and/or painted concrete and brick. (See Figure #1)

It is important to verify with a builder or engineer that an existing wall is strong and sound. Sandblast the surface to remove any paint or sealer if required. Rinse thoroughly. Once the surface has dried, Natural Thinstone Veneer can be applied directly to the clean surface. If this application is not reasonable, another option is to apply expanded metal lath to the painted or sealed surface with concrete screws or nails. Then apply a 1/2 inch scratch coat and allow 24 hours to dry.

NEW CONCRETE MASONRY WALL

Note - Including new concrete block and/or newly poured concrete walls. (See Figure #1)

No special preparation is required for a concrete block wall. When working with a poured concrete wall, it is important to take extra time to examine the entire surface as it may have areas of form release agents on the concrete surface. To remove this oil, contact an industry professional for recommended cleaning solutions and/or score the area with a wire brush. After these surfaces are cleaned, rinsed and allowed to dry, the Natural Thinstone Veneer can be installed directly to the concrete wall.

INSULATED CONCRETE FORMS

(See Figure #1)

Apply vapor barrier. Next install the expanded metal lath as specified by the manufacturer of the insulated forms. Concrete fasteners that secure the 2.5 lb galvanized expanded metal lath to the wall, will need to be long enough to penetrate clear through the insulation and secure into the cured poured concrete wall. Apply a 1/2 inch thick scratch coat, allow 24 hours to dry, and then apply your Natural Thinstone Veneer.

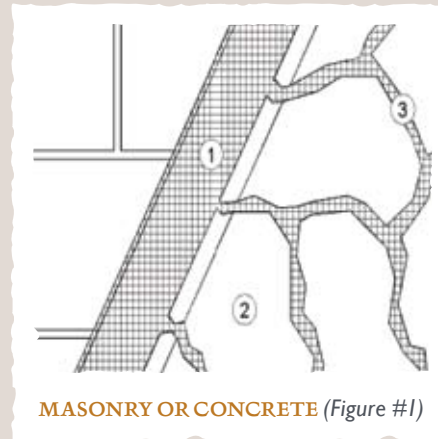

MASONRY OR CONCRETE (Figure #1)

- 1 Mortar applied directly to untreated masonry, concrete or stucco.
- 2 Natural stone veneer.
- 3 Mortar joint.

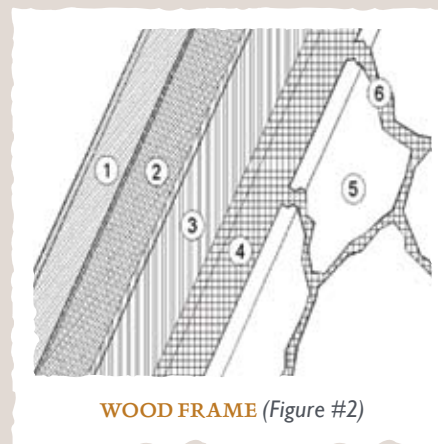

WOOD FRAME (Figure #2)

- 1 Sheathing
- 2 Building paper or vapor barrier
- 3 Galvanized metal lath
- 4 Mortar
- 5 Natural Thinstone Veneer

INSTALLATION REQUIREMENTS

(Read prior to installation)

- All exterior surfaces are required to have a water resistant barrier installed. (See local building codes.)
- Applications that use an expanded metal lath must use a lath that is corrosion resistant.
- When using expanded meal lath in your application, a 1/2 inch thick scratch coat must be created.
- It is recommended to allow a scratch coat at least 24 hours to dry.
- Safety Glasses and a dust mask should always be worn when cutting or trimming any of K2 Stone quarries products.
- Type 'S' mortar is utilized for all Natural Thinstone installations.
- The use of an acrylic bonding agent mixed in with the mortar is recommended to add strength to the installation.
- It is recommended that 100% of the back of each stone be covered by a minimum of 1/2 inch of mortar.
- If corner pieces are required for the application, the corner pieces should be installed prior to any flats.
- The use of an epoxy or thin set should be limited to interior applications.
- It is suggested that 48 hours after application, the stonework be watered down and a cleaning agent applied to remove any dirt.
- All of K2 Stone quarries products are washed prior to packaging.
- All local building codes must be adhered to at all times.

HOW TO INSTALL NATURAL THINSTONE VENEER

- 1 Properly prep the surface as previously described.
- 2 Mix Mortar (3 parts sand to 1 part type 'S' cement) to a creamy consistency. The use of an acrylic bonding agent mixed in with the mortar at a ratio of 5 ounces to each 30 kilogram bag of type 'S' cement is recommended to add bond strength to the installation.
- 3 Ensure surfaces are clean of dirt, sand, or loose particles.
- 4 Trowel Mortar scratch coat on wall approximately 1/2 inch thick over metal lath. Allow 24 hours to dry.
- 5 Slightly dampen the scratch coat in order to create a suction bond effect with the Natural Thinstone veneer.
- 6 Apply a thin coat of mortar onto the backside of stone. (See photo #3) This creates a tighter bond to the wall.
- 7 Press stone into mortar, rotating slightly, forcing some of the mortar to squeeze out freely. Any mortar forced out beyond the finished joint can be toweled to finish joint.
- 8 Use a grout bag or trowel to fill all the joints. As the mortar stiffens, tool to the desired depth and brush off all excess.

HOW TO CLEAN

Excess mortar and film may be removed using a certified cleaning solution (contact an industry professional for recommendations). Always choose a non-conspicuous area to test cleaning solution prior to application. Rinse thoroughly with clean water.

HOW TO SEAL

Stone may be sealed with a good quality breathable sealer only after thoroughly curing which takes 3 to 4 weeks on inside work. Follow manufacturers directions on the application of sealer. Sealers must be periodically reapplied, especially on exterior applications, and could alter the natural coloring of the stone. Always choose a non-conspicuous area to test sealer prior to application.

TYPICAL THINSTONE APPLICATIONS



FIELDSTONE



LEDGESTONE



CARMANAH COBBLES

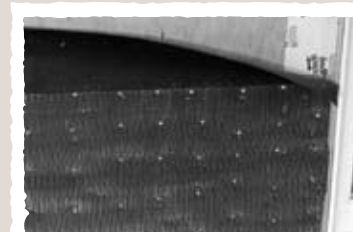

PHOTO 1 - Application of galvanized lath.



PHOTO 2 - Application of scratch coat to surface of exterior wall.



PHOTO 3 - Application of mortar onto Natural Thinstone Veneer.



PHOTO 4 - Application of Natural Thinstone Veneer.



STONE

your NATURAL choice

CONTACT US TODAY TO TURN YOUR IDEAS INTO REALITY!

We invite you to find out for yourselves what sets K2 Stone apart from other stone suppliers.

From our production facility and show room in Nanaimo to all our show room locations in Victoria, Surrey, Calgary and our dealers in the USA, we make stopping by an easy task. Drop by for a coffee and a tour sometime, and allow us to show you how we can help you achieve a beautiful, durable, and affordable new look for your home or garden.

K2 STONE - YOUR NATURAL CHOICE.

K2 STONE CORPORATE HEADQUARTERS

930 Maughan Road
Duke Point Industrial Park
Nanaimo, BC V9X 1J2
866.722.2420
www.K2STONE.ca

K2 STONE - MAINLAND

4311 King George Highway
(Next to Art Knapp Plant Land)
Surrey, BC V3S 0L2
877.598.3611

K2 STONE - VICTORIA

876 Langford Parkway
Langford, BC
250.727.7625

K2 STONE - CALGARY

#15, 777 - 64th Ave SE
Calgary, AB T2H 2C3
403.948.0333

FIND A DEALER NEAR YOU **866-722-2420**

NANAIMO . VICTORIA . SURREY . CALGARY . EDMONTON . KELOWNA

www.K2STONE.ca